

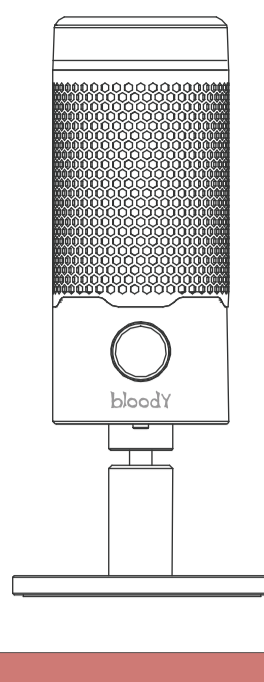

QUICK START GUIDE



GM50 PRO



WHAT'S IN THE BOX



Microphone



USB Type-C Cable

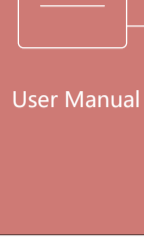

User Manual

KNOW YOUR PRODUCT

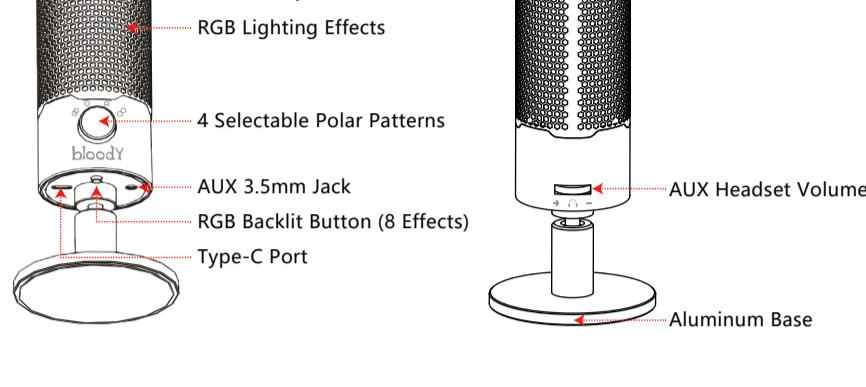

CONNECTION

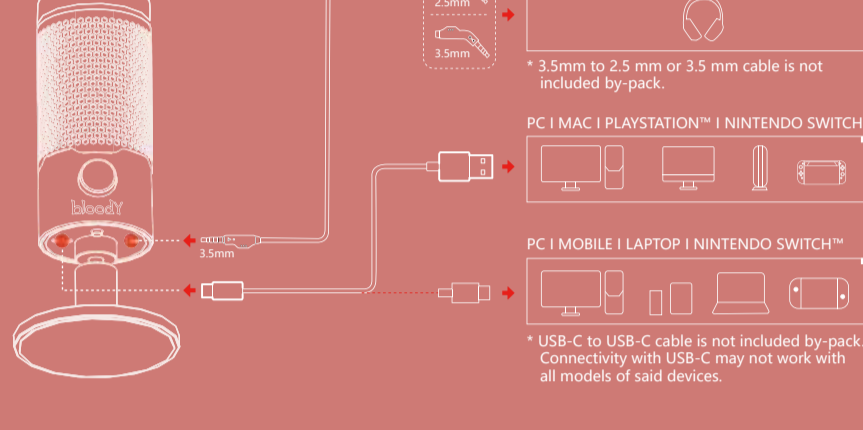

4 SELECTABLE POLAR PATTERNS

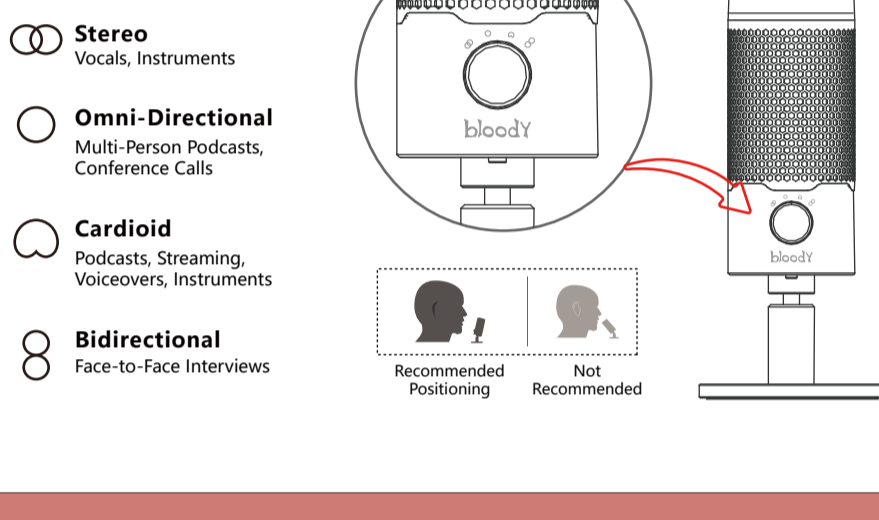

MICROPHONE VOLUME ADJUSTABLE



RGB BACKLIT EFFECT

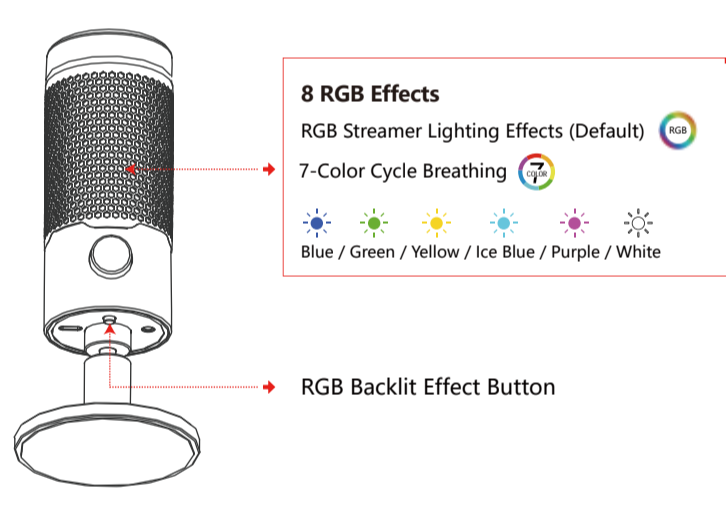

AUX HEADSET VOLUME ADJUSTABLE

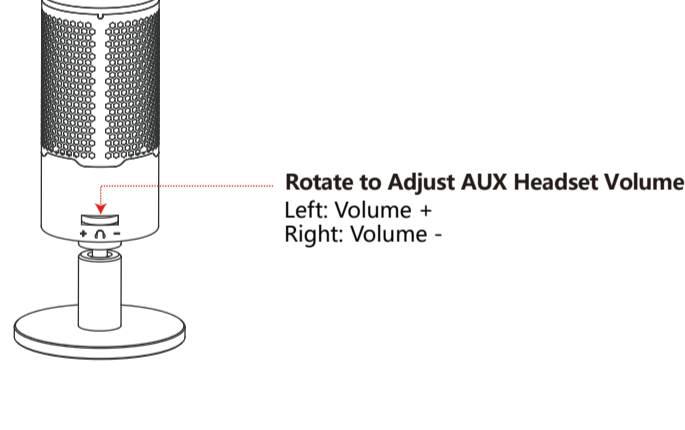

OTHER INSTALLATION

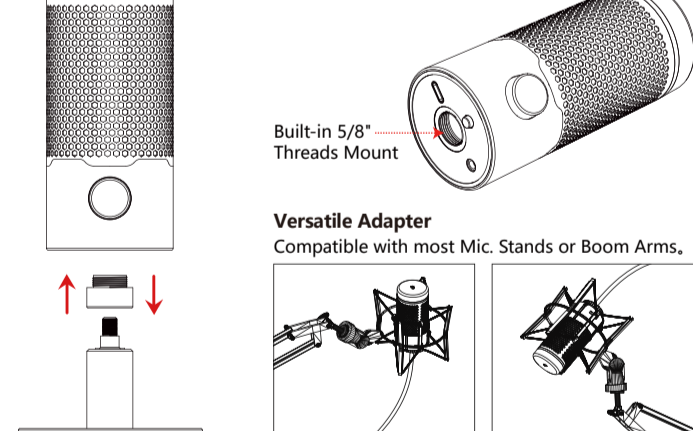

TECH SPEC

Bit Depth:	32 bit
Sample Rates:	192 kHz
Polar Pattern:	Stereo / Omni / Cardioid / Bidirect
Capsules:	14 mm Electret Condenser Microphone*3
Power Consumption:	5V=500 mA
Frequency Response:	20 Hz-20 kHz
Sensitivity:	-37 ± 3 dB
THD:	<0.1%
Signal-to-Noise:	> 95 dB
Size:	8 x 8 x 18.5 cm
Weight:	246g (w/o cable)
Cable Length:	250 cm USB Type-C Braided
System Support:	Windows 10 or later

SAFETY RULES

- Never disassemble or modify your microphone for any reason. Otherwise, it may cause the microphone to malfunction, which is not covered by the warranty.
- Do not get the device wet with liquids, otherwise will cause serious damage to the device. Damage caused by water entering the device will not be covered by the manufacturer's warranty.
- Please do not place the product in an environment where the temperature is too high or too low (above 45°C or below -20°C).
- Do not place your device's light close to your eyes.
- Do not use the device during a thunderstorm.



Bloody.com